

# LOCKMASTERS<sup>®</sup>

INCORPORATED

## LKM10K Lock Series Pilot Hole Installation Fixture

LKM10KIFACX

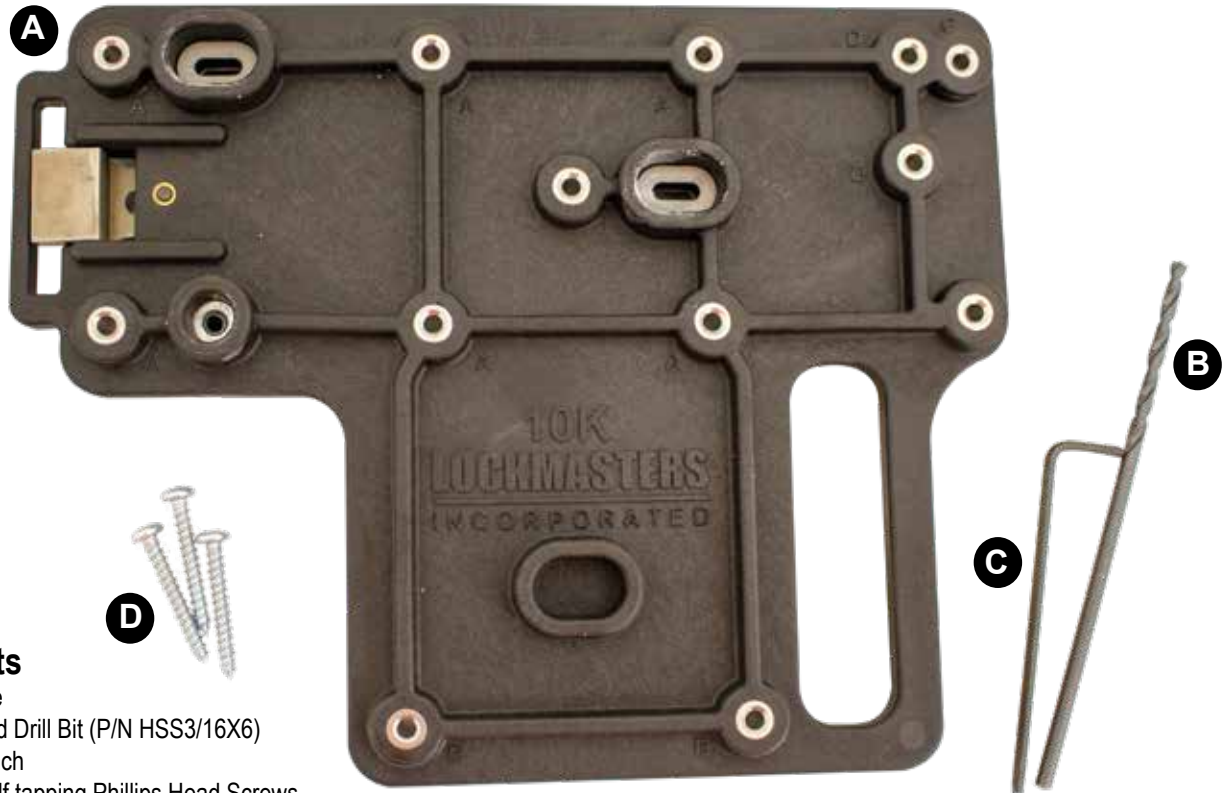

### Main Components

- A - Installation Fixture
- B - (1) 3/16" Extended Drill Bit (P/N HSS3/16X6)
- C - (1) 1/8" Hex Wrench
- D - (3) #10x1-1/2" Self tapping Phillips Head Screws

### NOTE:

Before proceeding with the lock installation, read and understand the LKM10KIFACX instruction manual, the lock's instruction manual and the templates provided with the lock.

Make sure all weather stripping, sound seals and brackets are in place on the door or frame before beginning the installation.

Follow ALL safety instructions provided with any power tools and wear the appropriate protective clothing, hearing and eye protection. The LKM10KIFACX is a multifunctional, economical installation fixture designed to prepare 3/16" pilot holes in doors for the LKM10K Series of locks. This includes the LKM10K (Push Pull Model) and LKM10KP (Panic Bar Model). It's design allows lock preparation on hollow metal or solid wood doors; Left or right hand, in swing and out swing.

2101 John C. Watts Drive  
Nicholasville, KY 40356  
800.654.0637 • 859.885.6041 • Fax 859.885.1731  
[www.lockmasters.com](http://www.lockmasters.com)

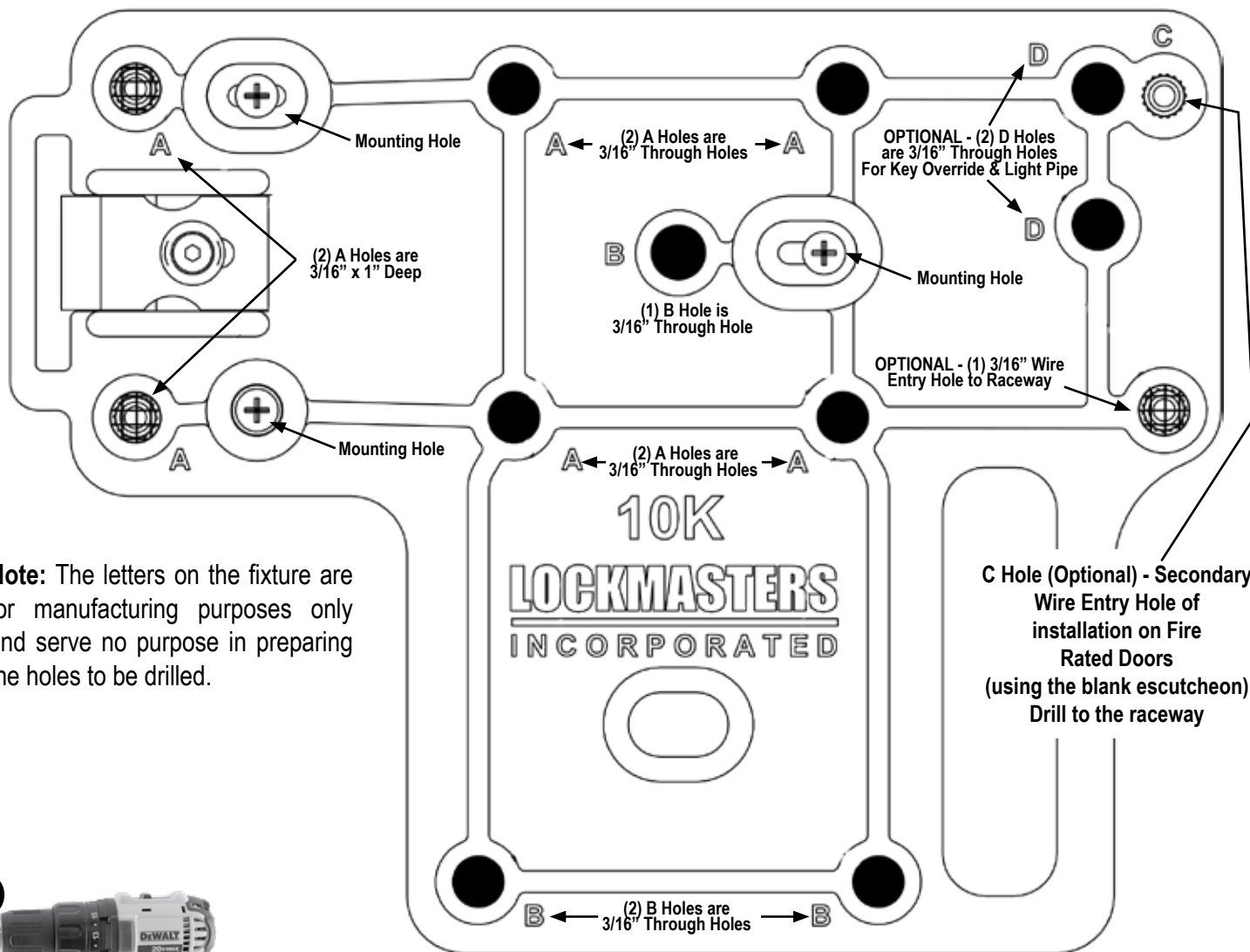

**Note:** The letters on the fixture are for manufacturing purposes only and serve no purpose in preparing the holes to be drilled.

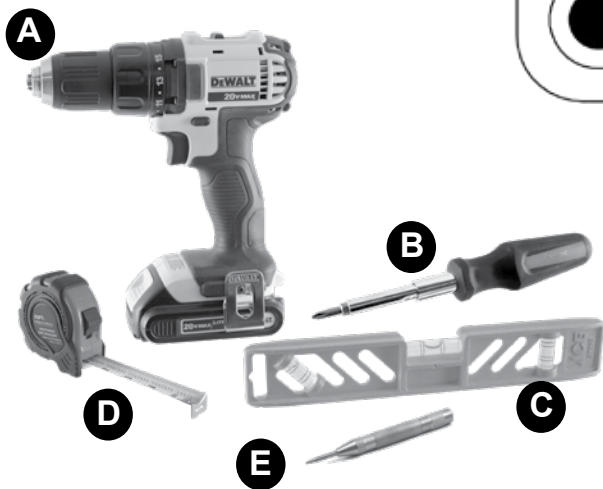

**Tools Needed:**

- A - Drill
- B - Phillips head screwdriver
- C - Level
- D - Tape measure
- E - Center Punch

**Step 1** - To meet ADA requirements, the strike needs to be mounted 43" from the center of the strike to the finished floor. Mark the frame 43" inches from the floor and extend the line across the door frame.



Step 1 - Measure 43" inches from the floor & mark. With a straight edge extend the mark across frame.

**Step 2** - Attach the strike to the door frame or bracket if applicable. If using the strikes provided with the LKM10K Series Locks, secure the strike to the frame with the provided double sided tape.

**Tip:** Lockmasters offers red magnetic installation strikes that can be moved and secured to a metal frame without permanently attaching the strike to the frame until the fixture is positioned properly and secured to the door.

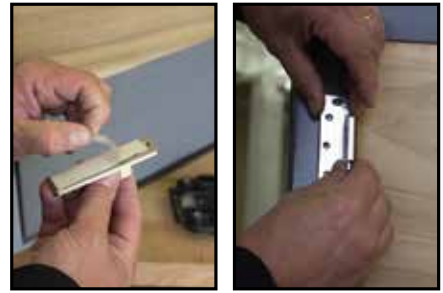

Step 2 - Temporarily attaching the strike to the frame

**Step 3** - It may be necessary to remove and flip the simulated lock bolt from one side of the fixture to the other depending on the door handing.

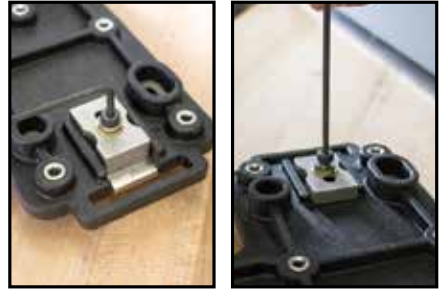

Step 3 - Flip the simulated lock bolt if necessary depending on the handling of the door

**Step 4** - Align the installation fixture on the door and over the strike. Check fixture with level. Make sure the fixture's bail does not contact any part of the strike.



Step 4 - Align the fixture over the strike with equal clearance around the bail and level.

**Step 5** - Once the fixture is in position, center punch the three fixture mounting holes. (See illustration). Remove the fixture.



Step 5 - Once in position and level, center punch the (3) mounting holes (see circled areas above)

**Step 6** - With a 1/8" drill bit, drill pilot holes for the (3) mounting holes and pre-thread with the provided self tapping screws.



Step 6 - Drill pilot holes for the (3) mounting holes and pre-thread the holes with the provided screws.

**Step 7** - Re-align the fixture to the door, level and slide simulated lock bolt into the strike. Insert and secure (2) self tapping screws into the center of the fixture's (2) slotted mounting holes in order to secure the fixture to the door.



Step 7 - Level fixture to the door and secure with (2) self tapping screws into the slotted mounting holes.

**Step 8** - Once the fixture is attached to the door, test the position of the bolt and strike by moving the simulated bolt in and out of the strike. The bolt should clear the strike on all four sides. If the bolt does not clear the strike opening it may be necessary to reposition or shim the strike or reposition the fixture by loosening the 2 mounting screws in order to slide the fixture left or right as needed.



Step 8 - Test the position of the bolt and strike by moving the simulated bolt in and out of the strike.

**Note:** If using the strikes provided with the LKM10K Series Locks, they are designed to allow slight adjustments to the strike via the oversized center mounting hole with an undersized screw to allow for strike movement.

**Step 9** - Once the fixture is in place and all adjustments have been made, insert and secure the 3<sup>rd</sup> self tapping screw to prevent the fixture from shifting while drilling the pilot holes.



Step 9 - Once in position secure the fixture to the door with the 3<sup>rd</sup> self tapping screw.

**Step 10** - Based on the fixture illustration, drill ALL through holes first with the provided 3/16" drill bit. Then proceed with remaining holes, but before drilling the pilot holes, mark the drill bit to prevent drilling too deep.

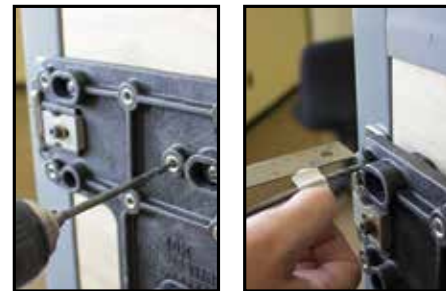

Step 10 - From the fixture illustration drill ALL the through holes. Then mark the bit to the correct depths to drill remaining holes.

**Tip:** Make sure the drill bit is completely inserted straight and level into the drill bushing and contacting the door's surface before drilling. This will ensure a straight thru hole and prevent premature wear on the fixtures drill bushings.

**Step 11** - Once all pilot holes have been drilled, remove the fixture from the door.



Step 11 - Fixture removed with ALL holes drilled including the optional Key Override and Wire Entry Hole

**Step 12** - Follow the written instructions provided with each LKM10K Lock Series to complete the lock install. Refer to the instructions for correct hole diameters and depths.